

# Connect to VPN: Macbook

Step 1) Open **System Preference**.  
Then select **Network**

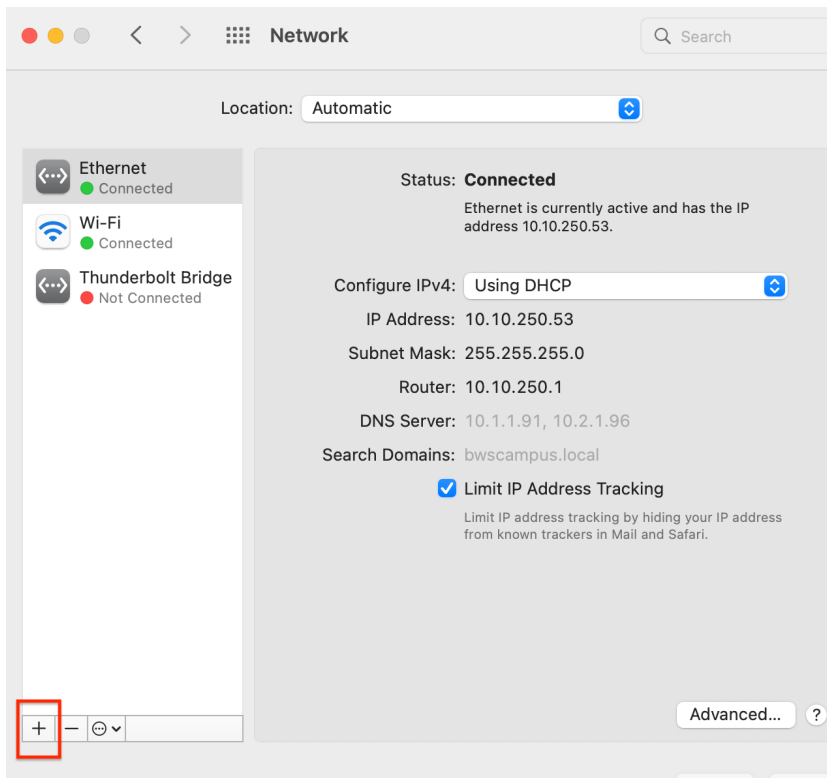
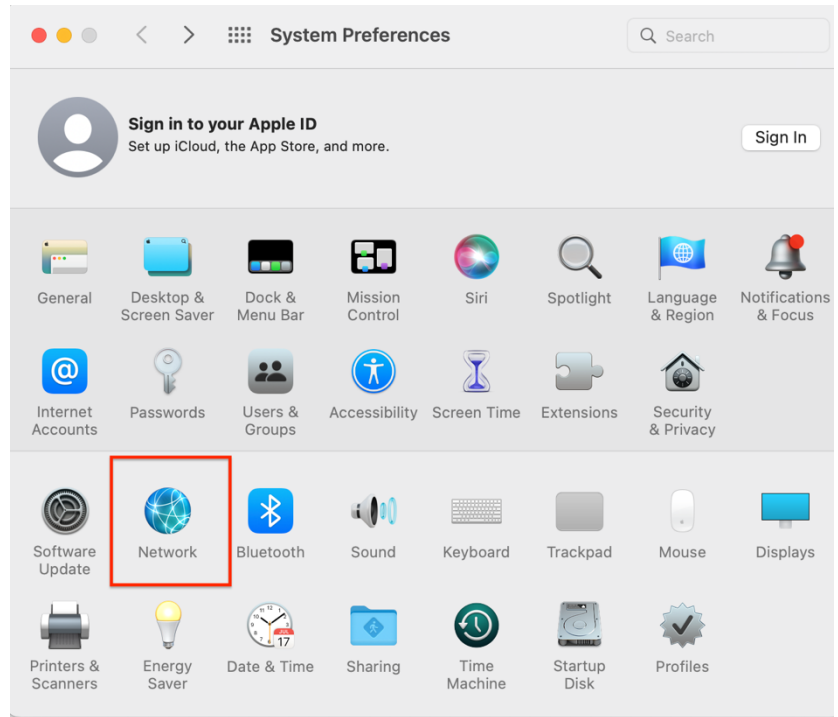

Step 2) Click the "+" button to create a new service, select VPN as the interface type, and choose **L2TP over IPsec** from the pull-down menu.

Step 3) Select the **VPN** option

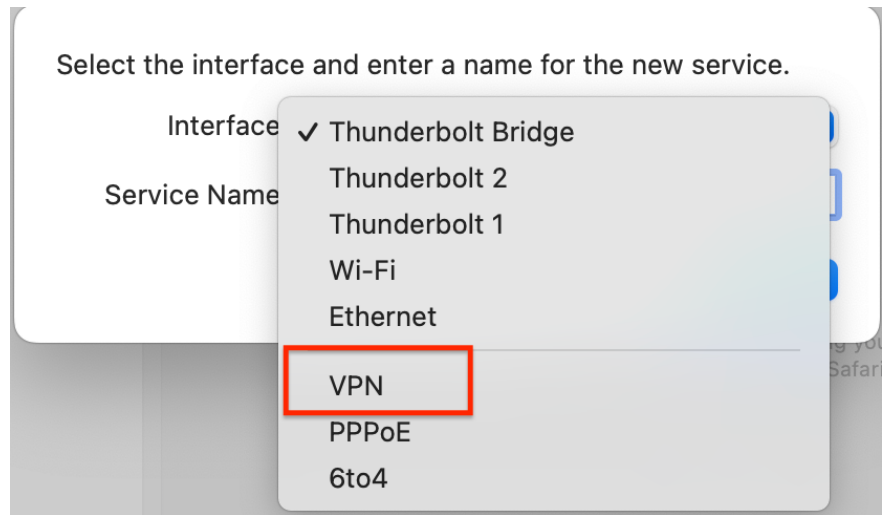

Step 4) Select the **L2TP over IPSec** option

Select the interface and enter a name for the new service.

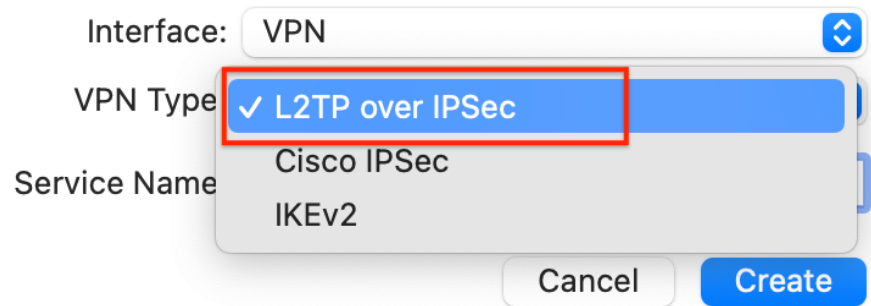

Step 5) In **Server Address:** please type gw.bwscampus.com  
For **Account Name:** please type your username (without @bwscampus.com)  
Then click on **Authentication Settings**

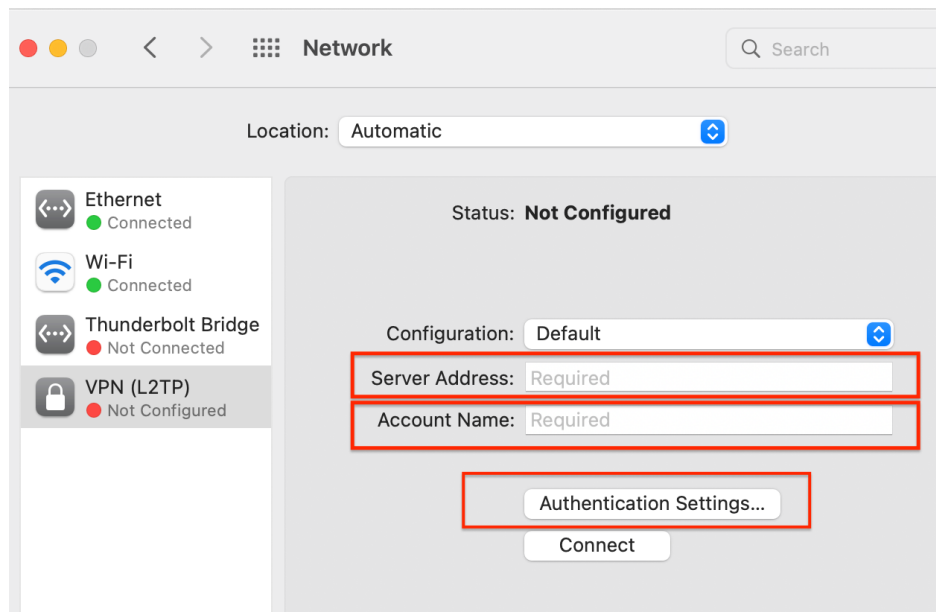

Step 6) On **User Authentication**: please type your Gmail password  
On **Machine Authentication**: please type BWSvpn90049  
Then click Ok

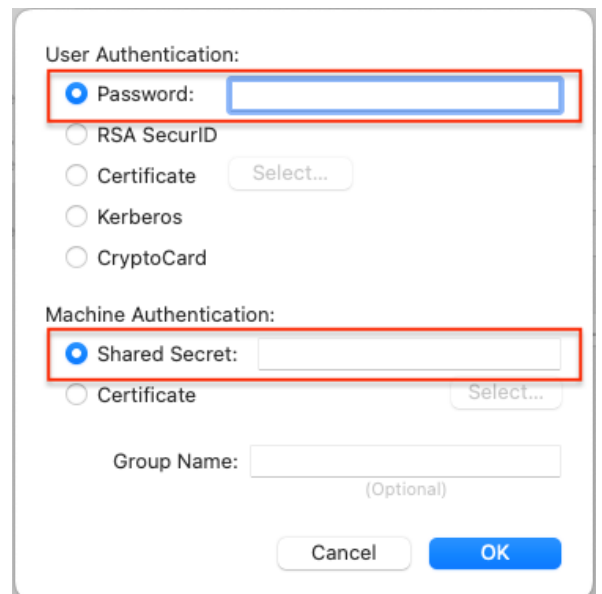

User Authentication:  
 Password:   
 RSA SecurID  
 Certificate   
 Kerberos  
 CryptoCard

Machine Authentication:  
 Shared Secret:   
 Certificate

Group Name:   
(Optional)

Step 7) Click on **Advanced**

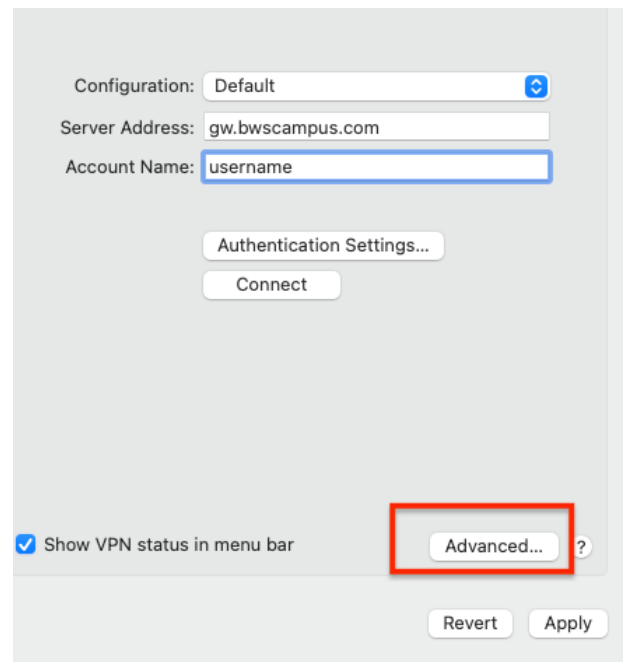

Configuration:    
Server Address:   
Account Name:

Show VPN status in menu bar  ?

Step 8) Please make sure the 3 checkboxes are selected  
\*Note: if the "Send all traffic over VPN connection" box is not selected then the VPN connection will not be established.

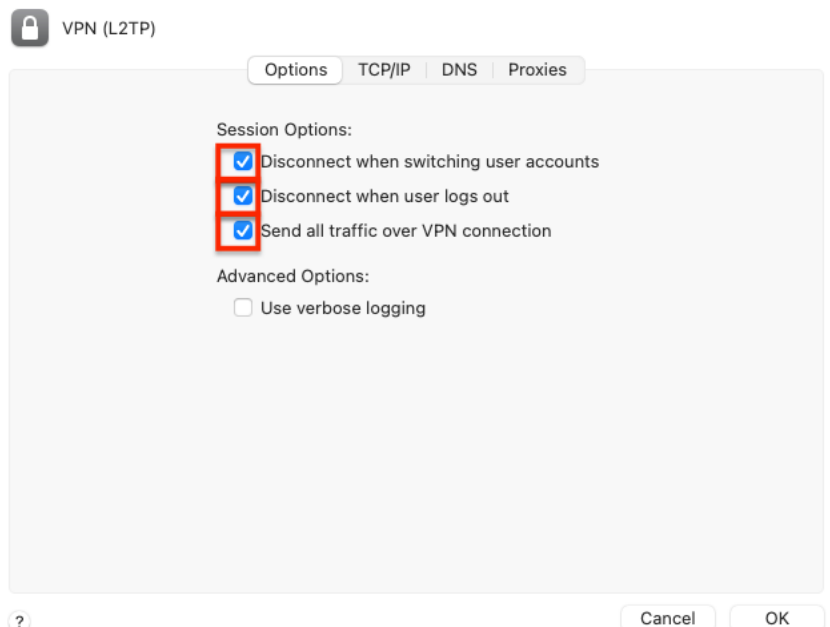

VPN (L2TP)

Options TCP/IP DNS Proxies

Session Options:  
 Disconnect when switching user accounts  
 Disconnect when user logs out  
 Send all traffic over VPN connection

Advanced Options:  
 Use verbose logging